

Cleaning a Slim Tube On your Open-Fit, Behind-the-Ear Hearing Aid



Why Do I need to clean my slim tube?

If you notice that you are not hearing as well as you did yesterday, there are two things to check: the battery and the slim tube.

- To see how to change a dead battery, check out our other tutorial entitled “Changing the battery in your hearing aid”

Other than a battery, the second biggest reason you may notice a decrease in your hearing is because your hearing aid tube is clogged with wax.

If your slim tube is clogged, you will notice a decrease in volume, or you may not hear any sound at all.

Note: Not all behind-the-ear hearing aids are slim tube hearing aids. Your hearing aid could possibly be a receiver-in-the-canal (RIC) aid, and if you're not hearing well, you may need to change your wax trap. If you're not sure what kind of aid you have, give us a call, and we'll help.

How do I know if I need to clean my slim tube?

You may need to clean your slim tube if:

- You're not hearing well. With your hearing aids on your ears, run your fingers over the top of the aids (behind your ear). If you hear a sandpaper-like sound, then your aids are on, and ok!
- If you do not hear any sounds from your hearing aids, check the battery.
- If you are still not hearing sounds with a new battery, you may need to clean the slim tube.

Step 1: Find a good location



Hearing aids and domes have a tendency to find their way to the floor. Try to find a counter top, desk, couch, or bed that is free of clutter. Ideally find a surface in a contrasting color to your hearing aid, so that if you drop it, you'll be able to find it.

Also, be aware of the color of the floor – if the hearing aid falls on the floor, you *really* want to find it fast!

Step 2: Remove the dome

Remove the hearing aid from your ear. Using a soft cloth or tissue wipe the silicone dome / tip area to remove any excess wax.

Firmly grasp the dome, and pull to remove. (Don't worry, you won't hurt anything!)

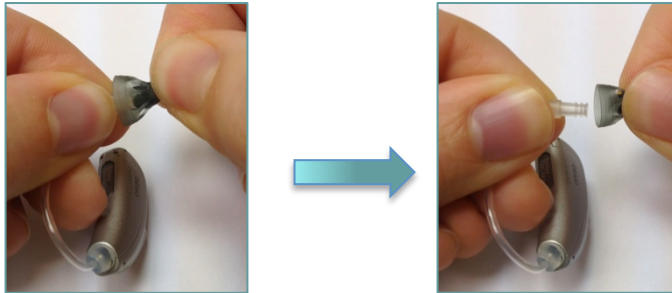
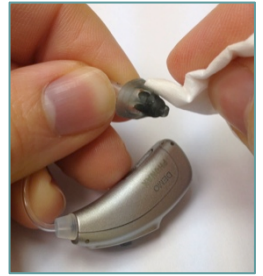

Step 3: Remove the slim tube

To remove the tube, grasp the tube near where it connects to the main part of the hearing aid. Simply twist the tube to unscrew it.

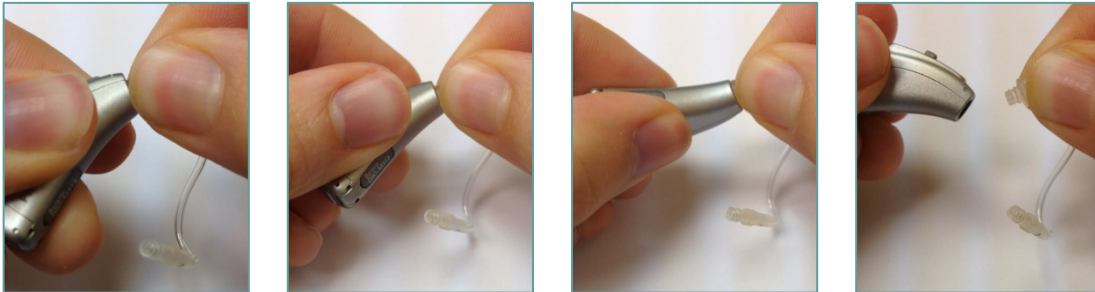

Step 4: Clean the slim tube

Find the little green, plastic wire. If you got your hearing aids from AHA, it's probably in the bag with your batteries and other supplies!

Starting at the end that was attached to the rest of the hearing aid, run the green wire through the tube. Grasp the other end and pull it out.



Repeat this step several times, or until you can see that there is no more wax or moisture in the tube.

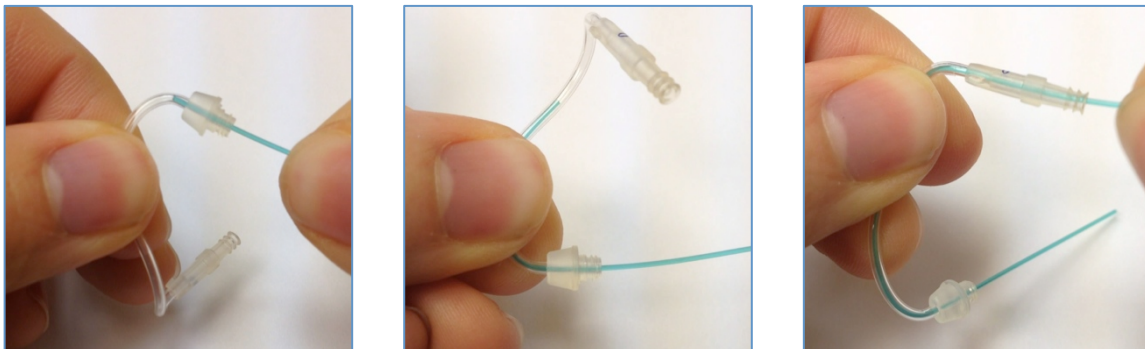

Advantage Hearing & Audiology
(800) 617-HEAR (4327)

(336) 271-4944 (Greensboro), (336) 623-2422 (Eden), (336) 497-5436 (Kernersville)
www.advantage-hearing.com

Step 5: Put the slim tube back on

Screw the tube back onto the hearing aid.

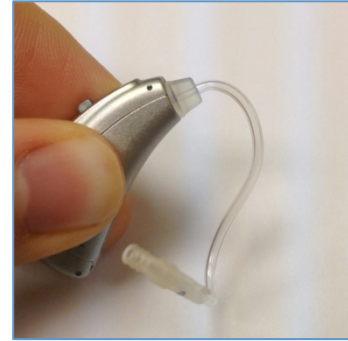
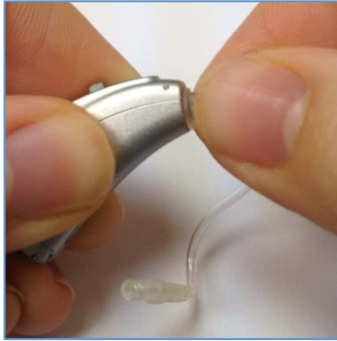
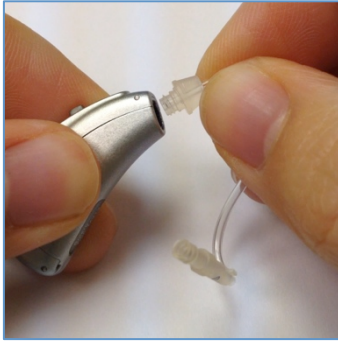

Step 6: Put the dome back on

Double check to be sure that the dome is clean. If you notice any wax, you can clean the tip with a cloth or alcohol swab.

Put your dome back on the tube. You should feel it “click” into place. There is a little sleeve where the dome fits onto the receiver, take a peek underneath to be sure it is lining up correctly!

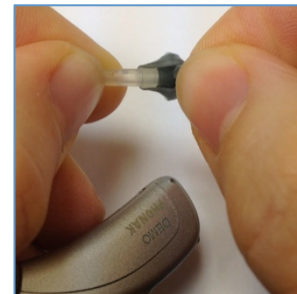
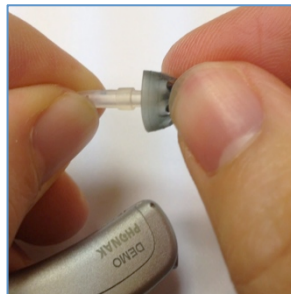
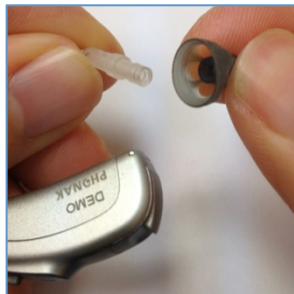

Problems? Questions?

If this does not fix the problem, call us and tell us that you changed the battery and cleaned the slim tube, but are still not hearing. We'll get you in as soon as possible!

If you have any trouble cleaning the slim tube or putting the dome back on, feel free to call or stop by, and we'd be happy to help you.